



**RAPID-EPS®**

TOTAL EDGE PROTECTION WITH EASE

## PRODUCT INSTALLATION GUIDE



# WEB FIX BRACKET

560mm - 9.5KG / 20.9LBS

425mm - 9.0KG / 19.8LBS

300mm - 8.5KG / 18.8LBS

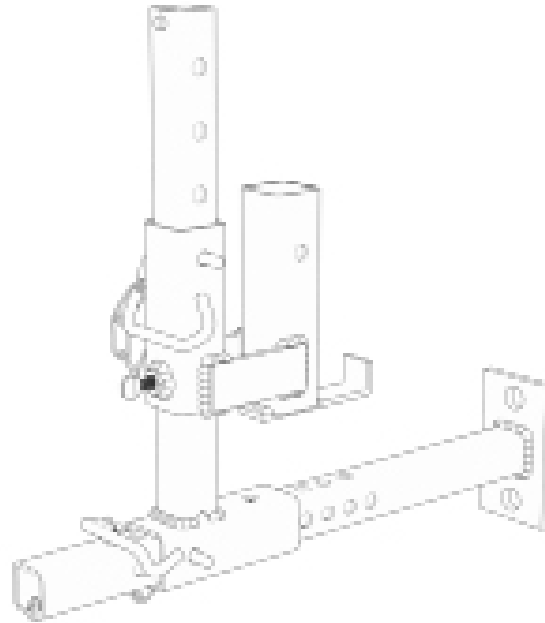

300MM / 12" - EU087 | 425MM / 1'5" - EU089 | 560MM / 1'10" - EU042 / NA042

**IMPORTANT:** REFER BACK TO COMPONENT DATA SHEET FOR AVAILABLE ADJUSTMENT.

Maximum Component Spacing

Web Fix  
Bracket

Steel Beam Web

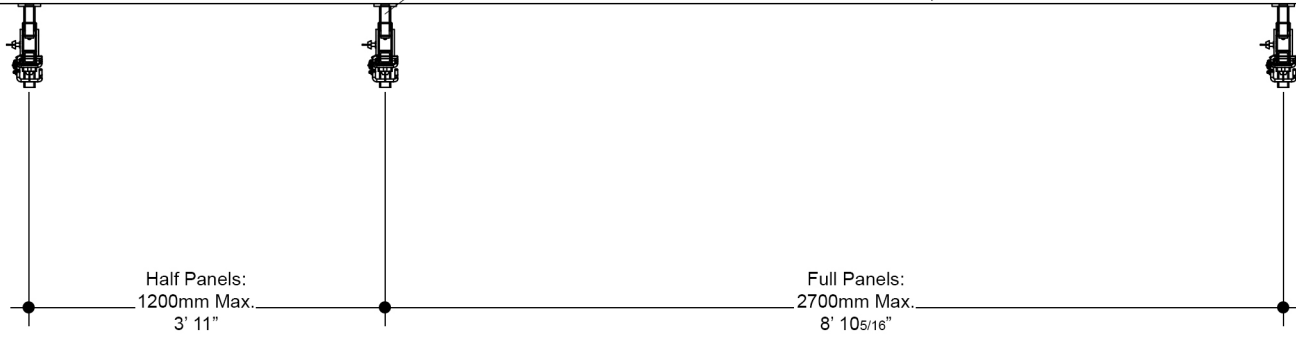

**IMPORTANT:** DISASSEMBLY PROCESS MUST FOLLOW THE INSTRUCTIONS IN REVERSE ORDER. IMPROPER INSTALLATION OR REMOVAL COULD RESULT IN SERIOUS INJURY OR DEATH.

1

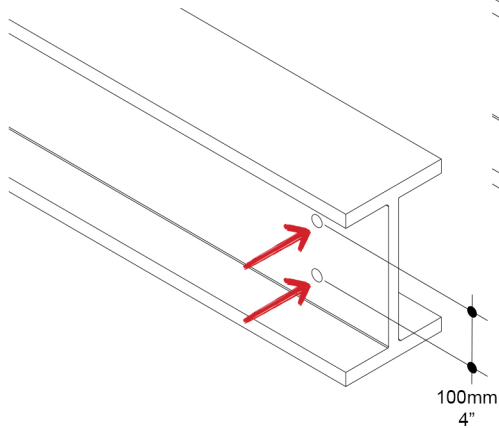

1. Drill 2No.  $\text{Ø}22\text{mm}$  ( $13/16''$ ) holes into the web of the steel beam (unless pre-drilled).

2

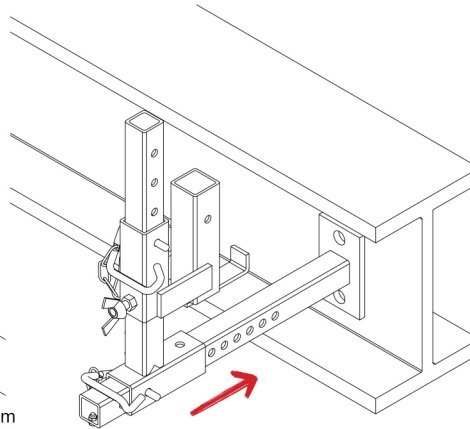

2. Position the Web Fix bracket in place and ensure the drilled holes align.

3

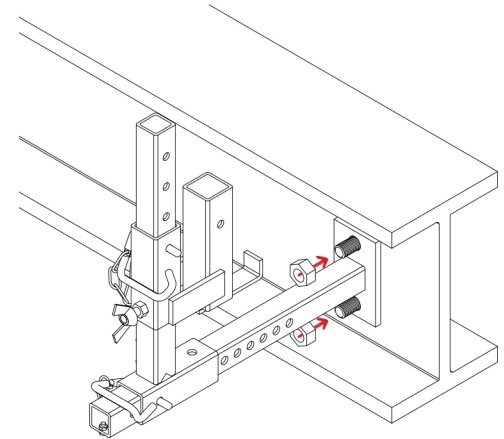

3. Bolt bracket to the beam using M20 x 60mm ( $3/4''$  x  $23/8''$ ) grade 8.8 nuts and bolts with the appropriate length to suit the application.

1

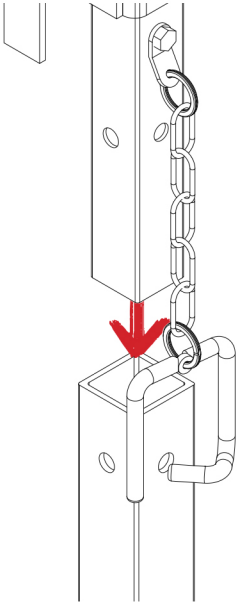

1. Place post into socket.

2

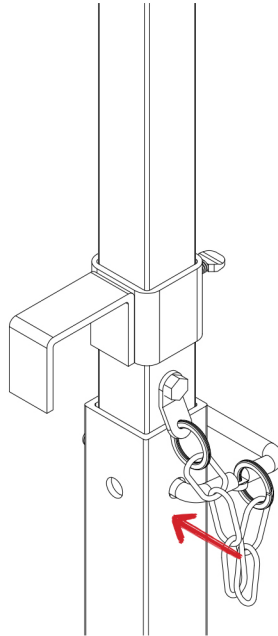

2. Push Rapid Pin through socket & steel frame post.

3

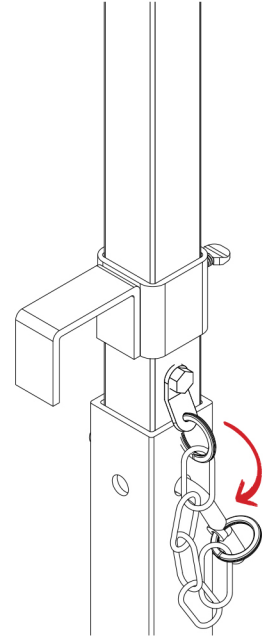

3. Rotate Rapid Pin into locked position.

# INDEXING - WEB FIX BRACKET

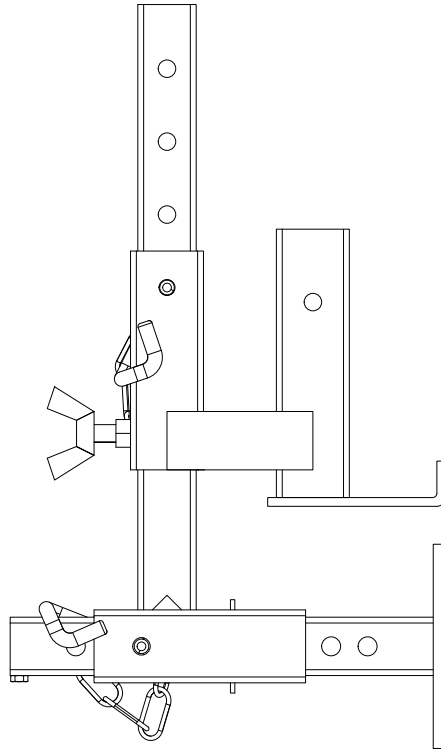

1

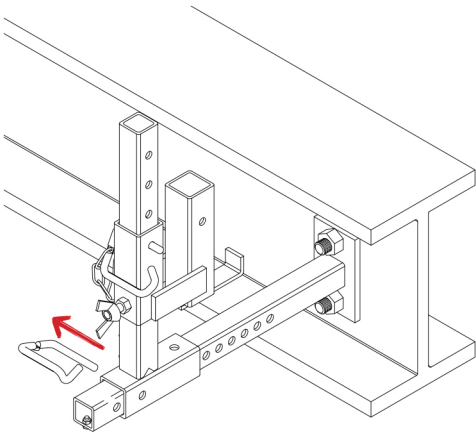

1. Remove Rapid Pin from sliding horizontal arm and loosen wingnut on side.

2

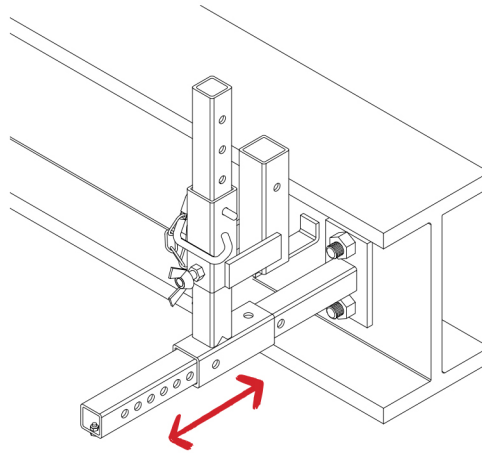

2. Slide the bracket to the required position.

3

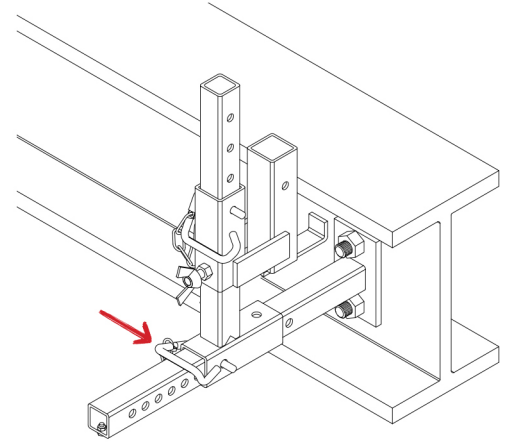

3. Insert the pin back into the bracket ensuring it is in the correct orientation with the red sticker not visible.

**IMPORTANT:** DISASSEMBLY PROCESS MUST FOLLOW THE INSTRUCTIONS IN REVERSE ORDER. IMPROPER INSTALLATION OR REMOVAL COULD RESULT IN SERIOUS INJURY OR DEATH.

4

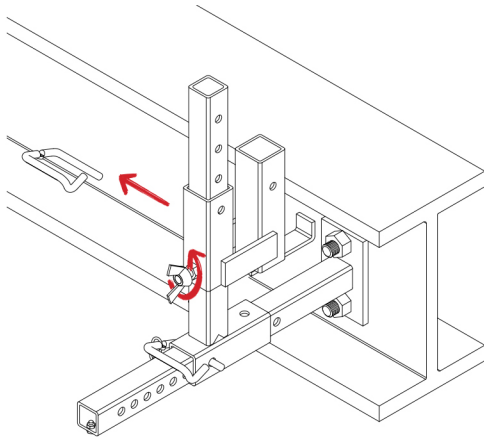

4. Loosen the wingnut and remove the Rapid Pin from the vertical sliding arm.

5

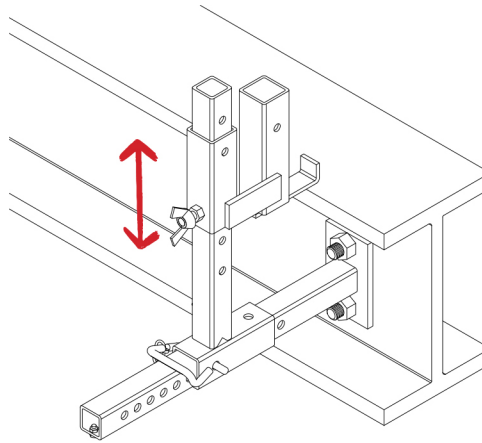

5. Slide the bracket to the required position.

6

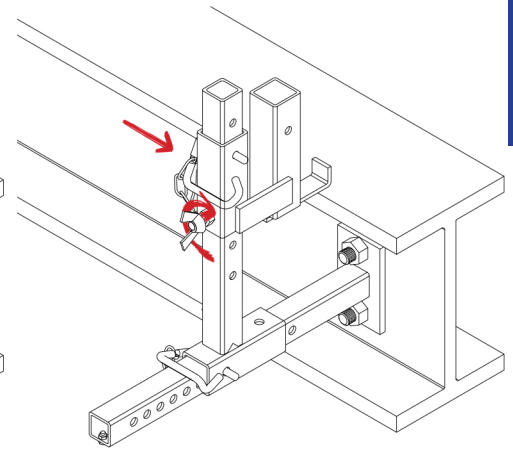

6. Insert Rapid Pin ensuring it is in the correct orientation (red sticker not visible) and tighten the wing nut to lock the arm in position.



1

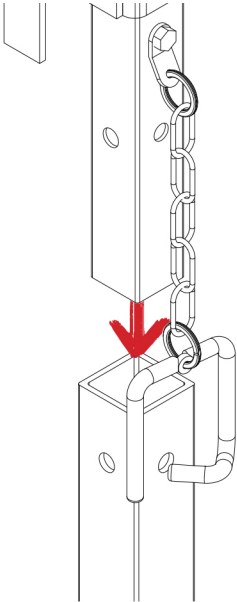

1. Place post into socket.

2

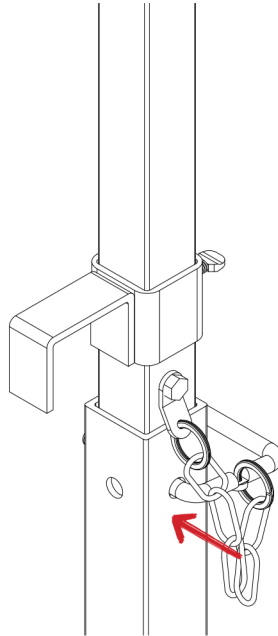

2. Push Rapid Pin through socket & steel frame post.

3

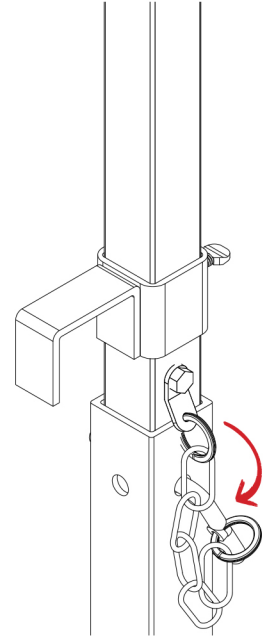

3. Rotate Rapid Pin into locked position.

# WEB FIX EXTENSION BRACKET

200mm - 1.8KG / 4.0LBS

400mm - 3.2KG / 7.0LBS

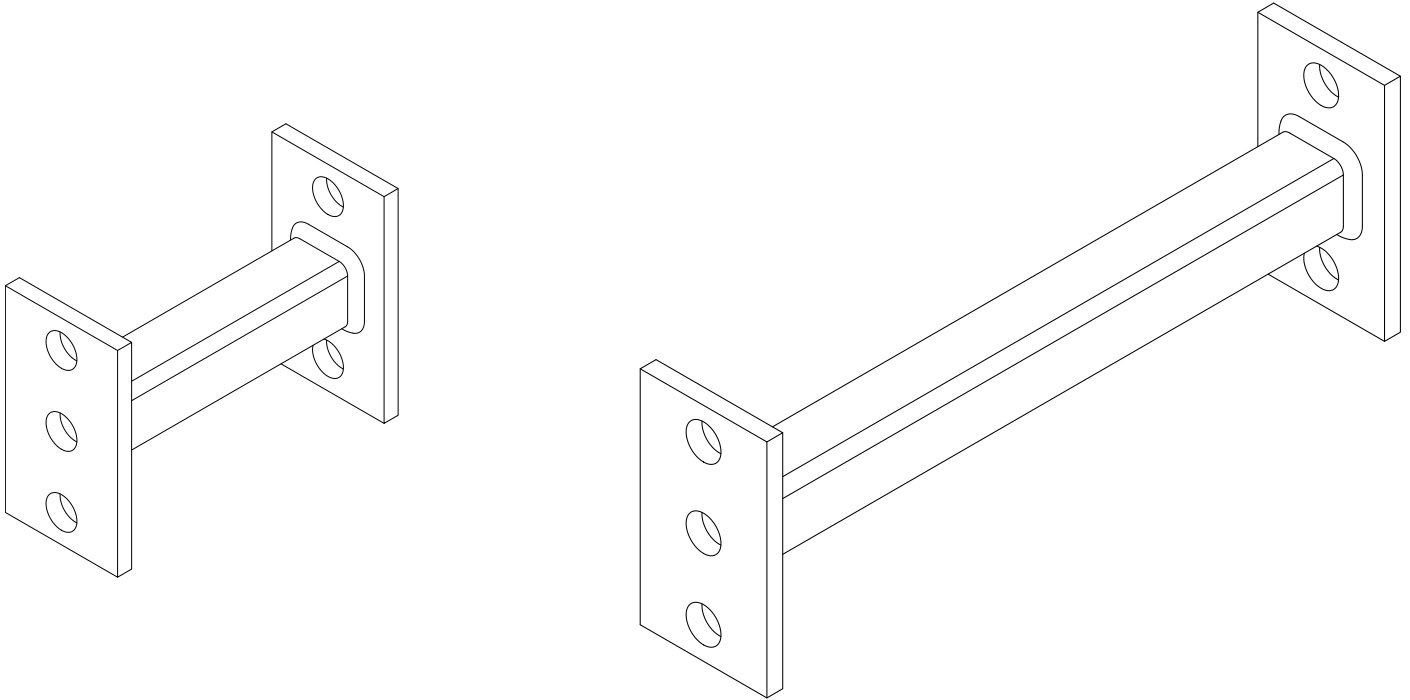

200MM / 8" - EU091 / NA094 | 400MM / 1'4" - EU092 / NA092

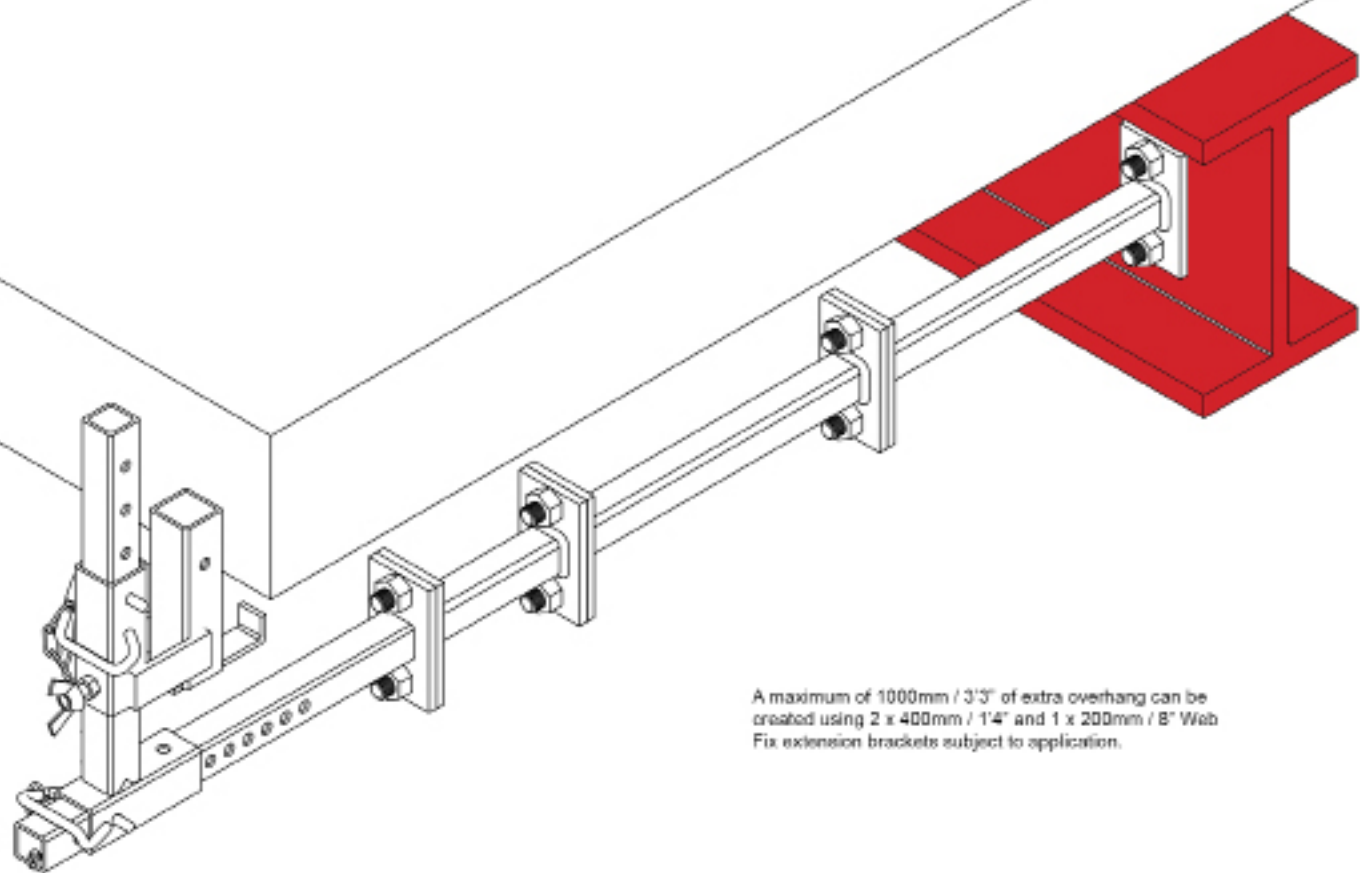

A maximum of 1000mm / 3'3" of extra overhang can be created using 2 x 400mm / 1'4" and 1 x 200mm / 8" Web Fix extension brackets subject to application.

**IMPORTANT:** DISASSEMBLY PROCESS MUST FOLLOW THE INSTRUCTIONS IN REVERSE ORDER. IMPROPER INSTALLATION OR REMOVAL COULD RESULT IN SERIOUS INJURY OR DEATH.

1

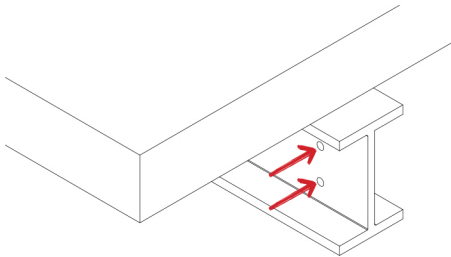

1. Drill  $\text{Ø}22\text{mm}$  /  $7/8''$  holes into web (unless pre-drilled steel).

2

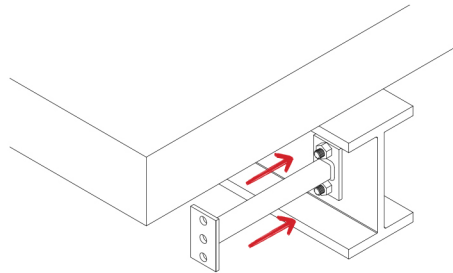

2. Bolt extension bracket to the beam using M20 ( $3/4''$  UNC) nuts and bolts with the length to suit the application.

3

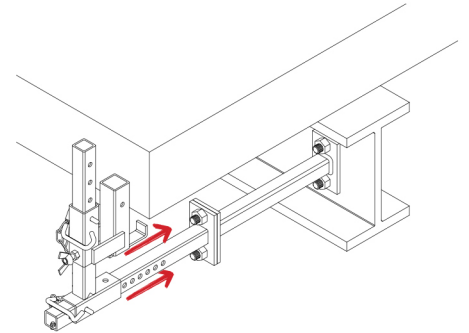

3. Bolt Web Fix bracket to the extension bracket using M20 ( $3/4''$  UNC) bolts and adjust using the Web Fix indexing guide.

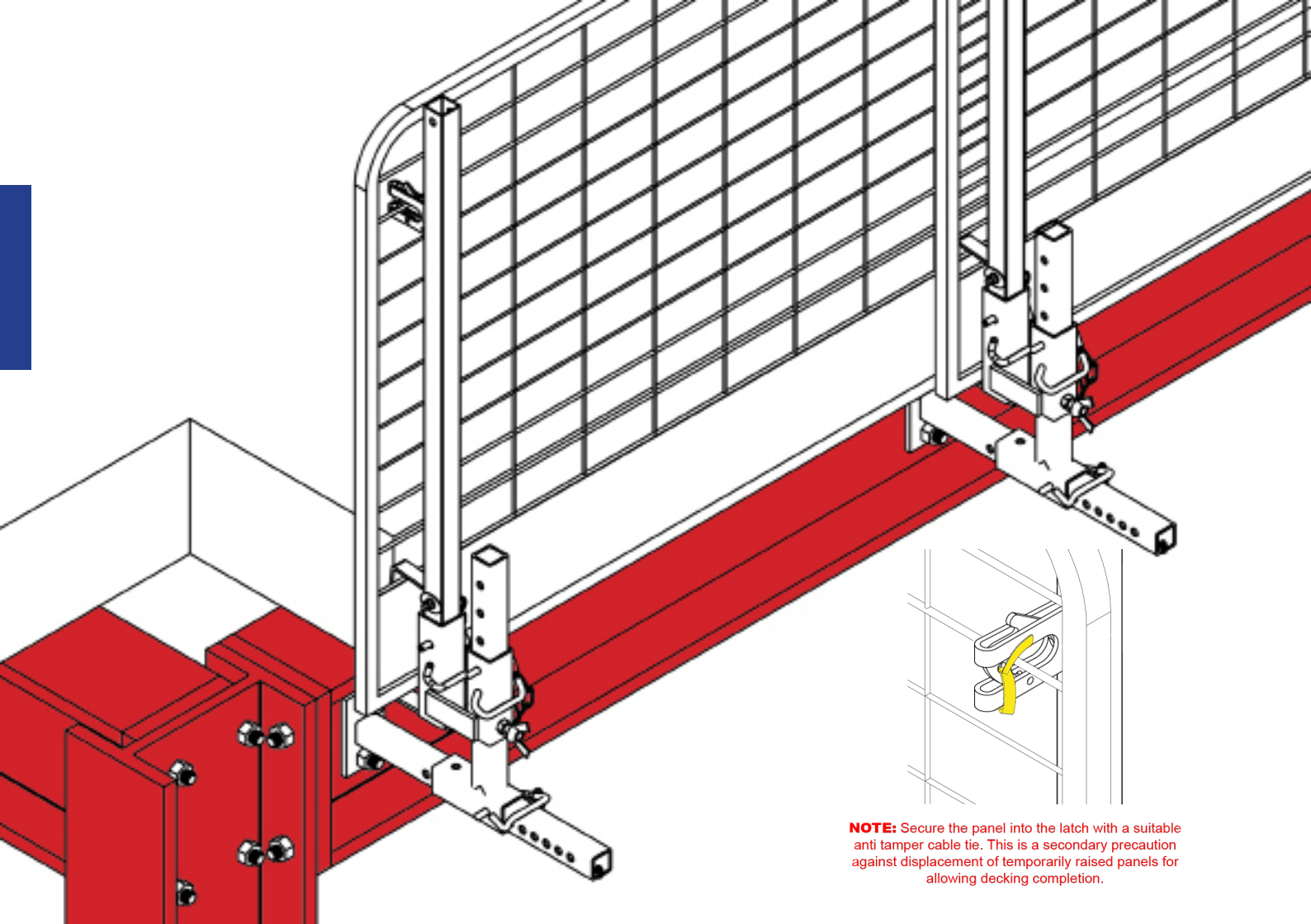

**NOTE:** Secure the panel into the latch with a suitable anti tamper cable tie. This is a secondary precaution against displacement of temporarily raised panels for allowing decking completion.

## BLIND BOLTS

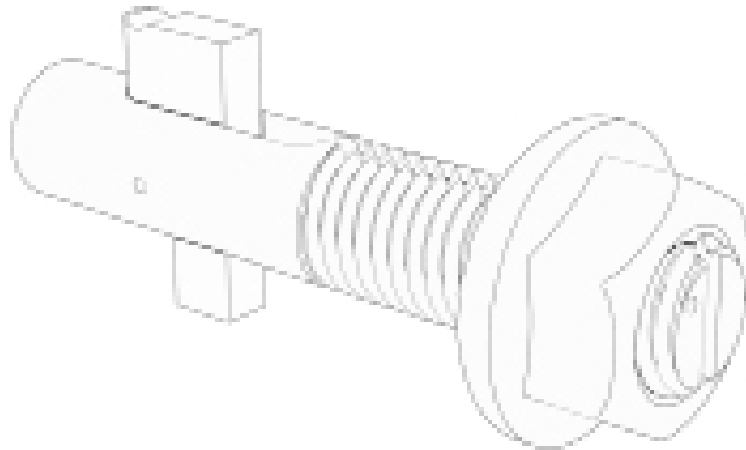

1

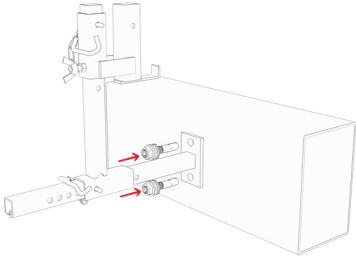

1. Hold product in place against steel and insert Blind Bolt into the 22mm / 7/8" holes with can rotated parallel with the bolt.

2

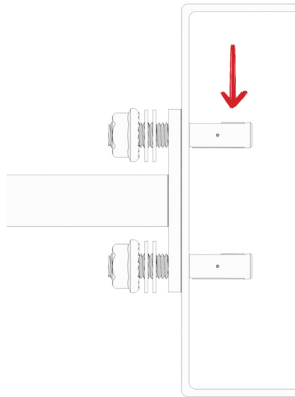

Note: Bolt should be orientated as above to fit into hole.

3

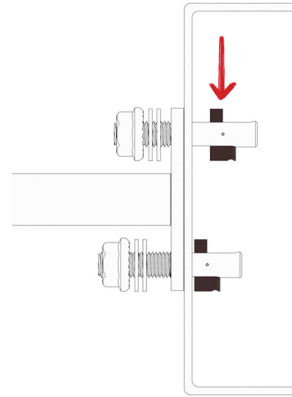

3. Rotate Blind Bolt 180 degrees so that the cam fall down into the locked position as shown above.

4

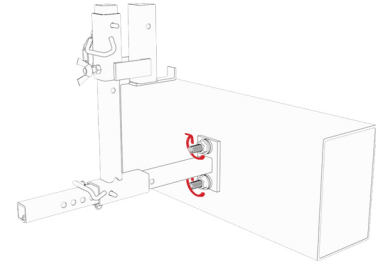

4. Tighten bolts up and ensure the product is held securely in position.

## FACE FIX OPTION

**IMPORTANT:** DISASSEMBLY PROCESS MUST FOLLOW THE INSTRUCTIONS IN REVERSE ORDER. IMPROPER INSTALLATION OR REMOVAL COULD RESULT IN SERIOUS INJURY OR DEATH.

1

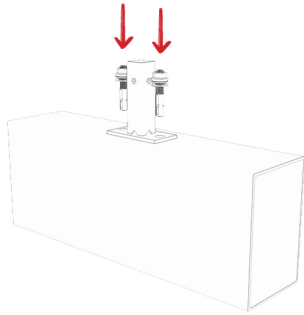

1. Hold product in place against steel and insert Blind Bolt into the 22mm / 7/8" holes with cam rotated parallel with the bolt.

2

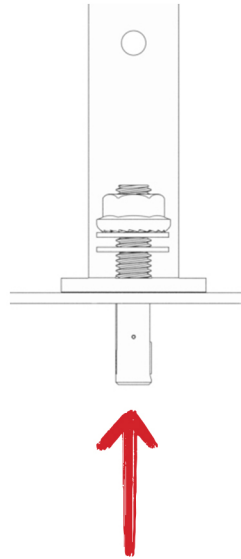

Note: Bolt should be orientated as above to fit into hole.

3

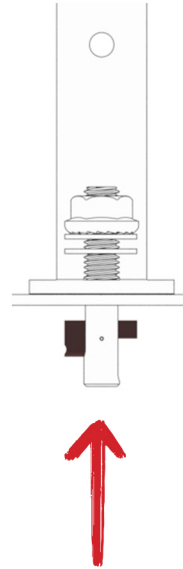

3. Ensure that the cam fall down into the locked position as shown above.

4

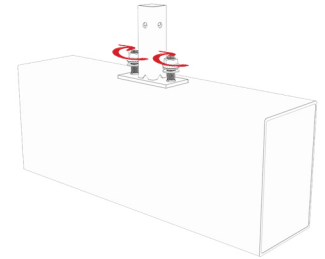

4. Tighten bolts up and ensure the product is held securely in position.

## TOP FIX OPTION



1

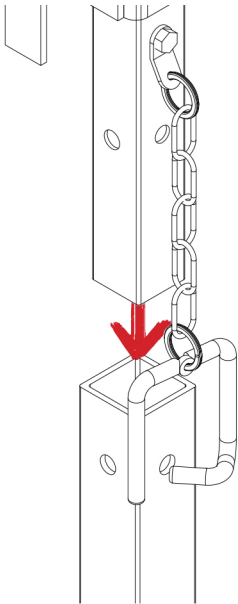

1. Place post into socket.

2

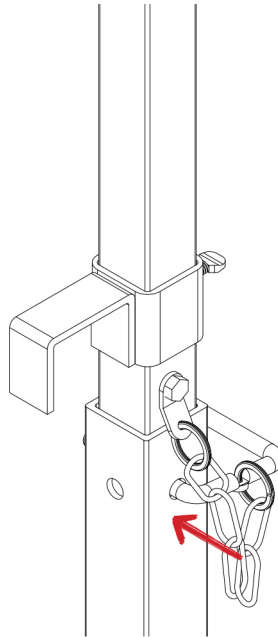

2. Push Rapid Pin through socket & steel frame post.

3

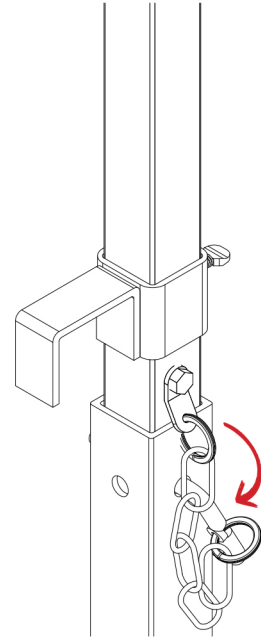

3. Rotate Rapid Pin into locked position.