



TOTAL EDGE PROTECTION WITH EASE

PRODUCT INSTALLATION GUIDE



Steel Frame Post & Panel Positions

1

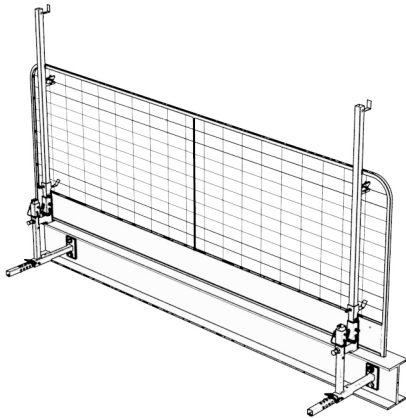

1. Single Height Edge Protection

2

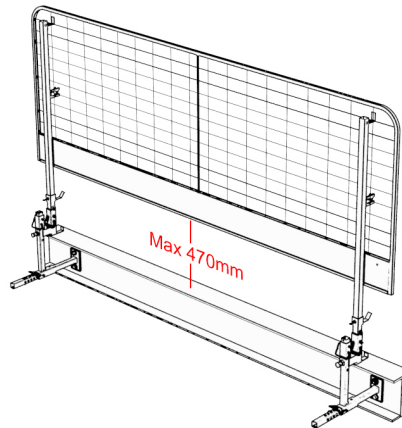

2. Lifted Height To Maximum 470mm For Temporary Works. **NOTE: PANEL TO BE LOWERED AFTER WORK UNDERTAKEN.**

3

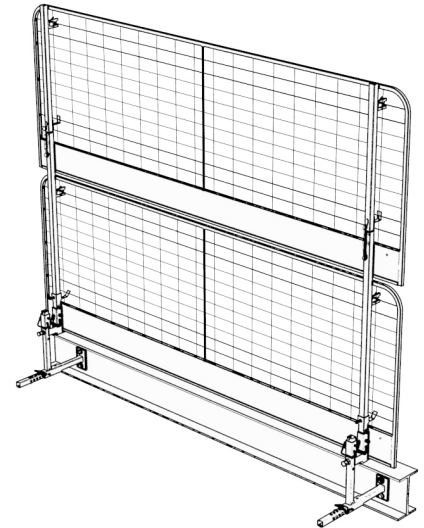

3. Double Height Edge Protection

STEEL FRAME POST - Mk2

WEIGHT - 6.0KG / 13LBS

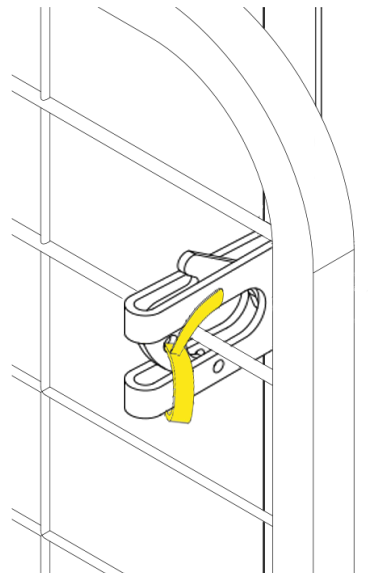

NOTE: Secure the panel into the latch with a suitable anti tamper cable tie. This is a secondary precaution against displacement of temporarily raised panels for allowing decking completion.

SF011

IMPORTANT: DISASSEMBLY PROCESS MUST FOLLOW THE INSTRUCTIONS IN REVERSE ORDER. IMPROPER INSTALLATION OR REMOVAL COULD RESULT IN SERIOUS INJURY OR DEATH.

1

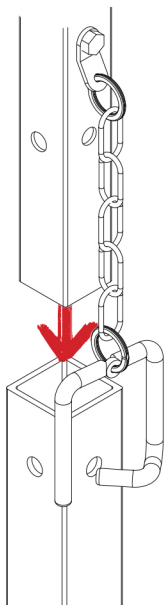

1. Place post into socket.

2

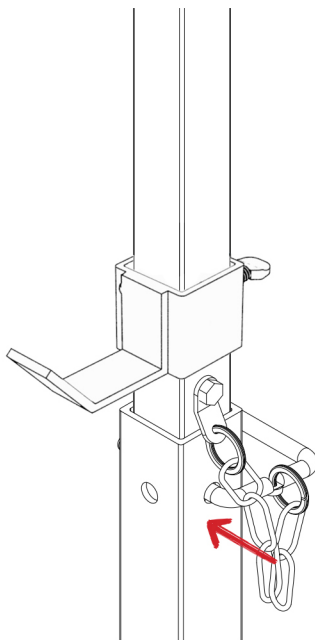

2. Push Rapid Pin through socket & steel frame post.

3

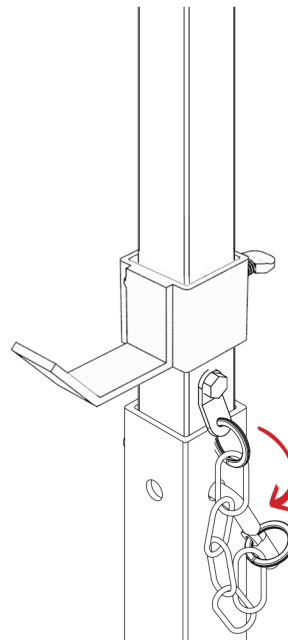

3. Rotate Rapid Pin into locked position.

EXTENSION POST (550MM)

WEIGHT - 2.0KG / 4.4LBS



EU012 / NA012

IMPORTANT: DISASSEMBLY PROCESS MUST FOLLOW THE INSTRUCTIONS IN REVERSE ORDER. IMPROPER INSTALLATION OR REMOVAL COULD RESULT IN SERIOUS INJURY OR DEATH.

1

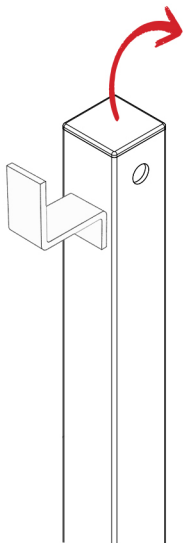

1. Remove plastic cap from the top of the post.

2

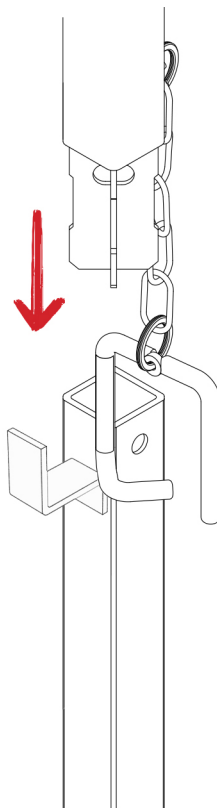

2. Insert the extension post.

3

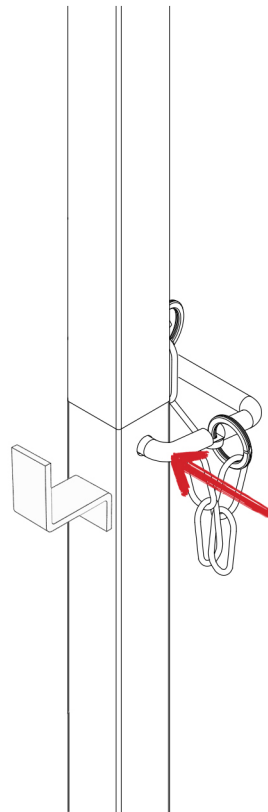

3. Push Rapid Pin through the post and the extension post.

4

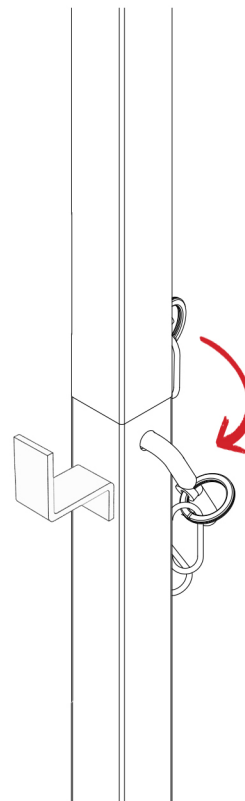

4. Rotate pin into locked position.

**THINK
WORK
HOME** **SAFE**